

Installation Instructions:
 Kit#: **1-117 (4DR), 1-118 (2DR)**
BODY MOUNT BUSHING KIT
JEEP JK WRANGLER 07-11

PARTS LIST:

PART#:	DESCRIPTION	QTY:
BOLT-148	M12-1.75 X 90 HHCS G10.9 ZINC	2 2
BOLT-42	3/8-16 X 1 1/4 HEX CAP SCREW	24 16
NUT-1125	3/8-16 NYLON HEX NUT	24 16
PLT-1270	TOYOTA P/U BDY MNT PLATE GLD ZNC	12 8
SLV-61063	.750 X .563 X 2.350 GOLD ZINC	12 8
U-68091	TOYOTA P/U BDY MNT LWR LRG 95-00	12 8
U-76000	JEEP JK BODY MNT BUSH UPPER 07-11	12 8
WASH-1161	1/2"X2.500X0.100 FLAT WASH GOLD	24 16
WASH-31	5/16" USS FLAT WASHER ZINC	24 16
		4DR 2DR



Please refer to a factory service manual before any disassembly or reassembling of your vehicle for proper instructions. Check service manual to ensure proper torque specs during installation.

NOTE:

- Prothane bushings generally do **NOT** meet in the center. The "crush" or amount the bolt can be tightened is determined by the length of the sleeve.
- For all articulating bushings, make sure to apply SUPER GREASE (supplied) to **ALL SURFACES** of bushings that contact metal.
- For all stationary bushings, we recommend applying a light coat of lithium or teflon grease (not supplied) to OD and ID of bushings to aid installation.
- **REUSE** all factory hardware unless replacement pieces are supplied.

Prothane Motion Control highly recommends this and all our polyurethane suspension kits be installed by a qualified technician.

INSTALLATION:

****NOTE:** Before and during install, take care to note all body mount positions and respective parts (mount size/type, washers, spacers, bolts, shims, etc.) as some factory hardware pieces (not included in this kit) may have to be reused. Each vehicle, depending on model will have 3-6 mounts per side located between frame and body.**

- 1) **SPRAY** liberally all mounting bolts and nuts to be removed with penetrating oil (ie. WD-40).
- 2) **SUPPORT** vehicle body properly before removing mounts. (**RECOMMENDED:** Use a 2"x4" piece of wood 24" long or any other suitable size between the jack and body panels to spread the load out so as not to damage body panels). If necessary, support the body in several areas.
- 3) **LOOSEN** all nuts and bolts but **DO NOT REMOVE**. Working from one side of the vehicle at a time **REMOVE** the nut and bolt from **ONE** mount location and raise body enough to replace mount, **NEVER HIGHER**. Check other areas of the body for interference problems when raising the body.
- 4) **REPLACE** one mount at a time with similar size urethane mounts. If washers/sleeves have been provided, use in combination of original factory metal parts that are not replaced by hardware supplied in kit. **SEE DIAGRAM for frame position and assembly order.**
- 5) After all mounts have been replaced, **TORQUE ALL NUTS AND BOLTS TO FACTORY SPECIFICATIONS.**

-NOTE: RETORQUE all nuts and bolts after initial settling of mounts (approximately 1000 miles of driving) to insure that fasteners have not come loose.-

Assembly View:

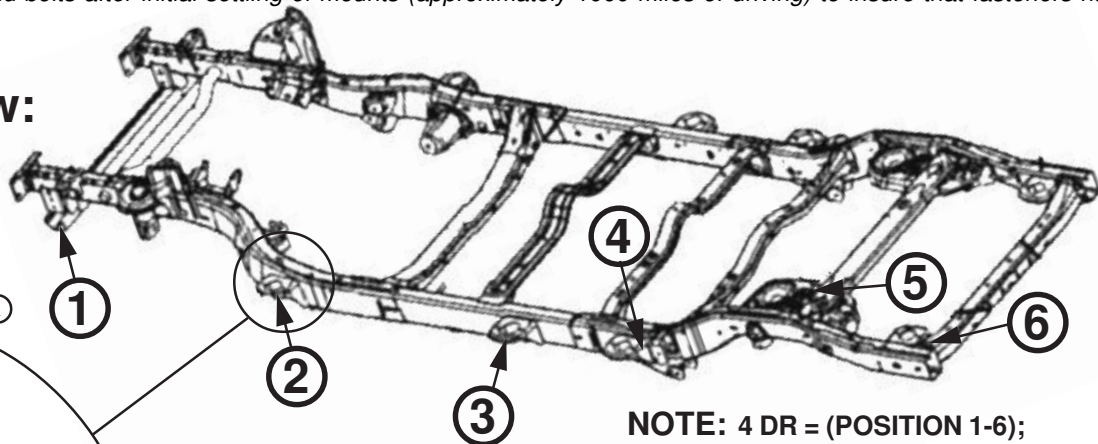

NOTE: 4 DR = (POSITION 1-6);
 2 DR = (POSITION 1,2,5&6)

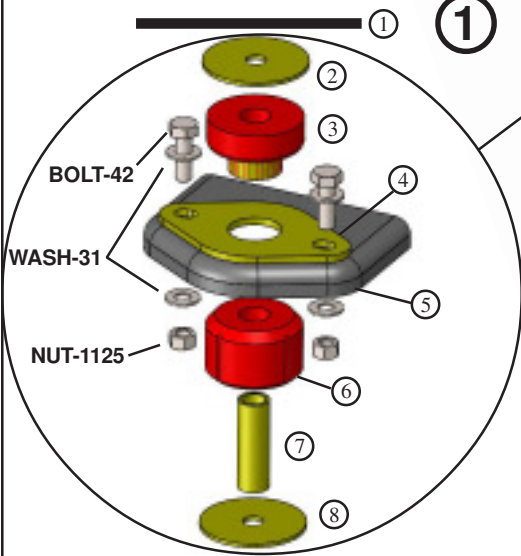

ALL POSITIONS

- 1) **BODY**
- 2) **WASH-1161** (2.5"OD x 1/2"ID)
- 3) Upper Mount - **76000**
- 4) **PLT-1270** (GOLD PLATE)
- 5) **Frame**
- 6) Lower Mount- **68091**
- 7) **SLV-61063** (3/4"OD x .563" ID x 2.350")
- 8) **WASH-1161** (2.5"OD x 1/2"ID)
- 9) **Reuse Original Nut and Bolt** (NOTE: Use longer supplied bolts (**BOLT-148**) for POSITION 1.)