

**TOP SIDE BAR TUBE AND
TOP SUPPORT CROSSBARS KIT PAGE 3 FIG B**

- 2 - TOP SIDE BAR TUBES (RT & LT)
- 1 - TOP SUPPORT CROSSBARS (40 3/8 ")
- 4 - 3/8 X 1 1/4 CARRIAGE BOLTS
- 4 - 3/8 USS FLATWASHERS
- 4 - 3/8 NYLON LOCKNUTS

**LOWER RUBBER BUMP STOP KIT
FIGURE B , PAGE 8**

- 2 - 1 1/2 " RUBBER BUMP STOPS
- 2 - 5/16 X 3 1/2 ALL THREAD TAP BOLTS
- 4 - 5/16 FLATWASHERS
- 6 - 5/16 NUTS
- 2 - 5/16 VINYL COVERS
- 2 - 3/8 FENDER WASHERS (1 1/2 " DIA.)

TOP RUBBER BUMP STOP KIT PAGE 8 , FIG A

- 2 - 2 1/2 " RUBBER BUMP STOPS
- 2 - 3/8 X 3 ALL THREAD TAP BOLTS
- 6 - 3/8 FLATWASHERS
- 6 - 3/8 JAM NUTS
- 2 - 3/8 VINYL COVERS
- 2 - 3/8 FENDER WASHERS (2 1/2 " DIA.)
- 4 - 3/8 LOCKWASHERS

LOWER SUPPORT BRACKET KIT PAGE 5

- 2 - LOWER SUPPORT BRACKETS
- 2 - INSIDE THREADED SUPPORT BRACKETS
- 2 - 1/4 X 1 1/4 SQUARE WASHERS
- 2 - 3/8 LOCKWASHERS
- 2 - 3/8 FLATWASHERS (1" DIA.)
- 2 - 3/8 NUTS
- 6 - 5/16 POINTED ALLEN SET SCREWS
- 6 - 5/16 JAM NUTS
- 1 - 5 /32 ALLEN WRENCH

WEATHER PROOFING

TO HELP WEATHER PROOF THE CONNECTING POINTS OF THE ROOF RACK, WE RECOMMEND USING BLACK SILICONE . (NOT SUPPLIED)

FRONT RUBBER BUMP STOP KIT PAGE 3 & 7

- 2 - 2 1/2 " RUBBER BUMP STOPS
- 2 - 3/8 X 2 1/2 ALL THREAD TAP BOLTS
- 4 - 3/8 FLATWASHERS
- 4 - 3/8 JAM NUTS
- 4 - 3/8 LOCKWASHERS
- 2 - 3/8 FENDER WASHERS (2 1/2 " DIA.)

FRONT AND REAR CONNECTING TUBE KIT PAGE 4, 6 & 7

- 1 - FRONT CONNECTING TUBE (28 7/8 ")
- 1 - REAR CONNECTING TUBE (38 ")
- 4 - 5/16 X 1 BUTTON HEAD ALLEN BOLTS
- 4 - 5/16 LOCKWASHERS
- 4 - 5/16 EXTRA THICK FLATWASHERS
- 1 - 3/16 ALLEN WRENCH

REAR SUPPORT BRACKET KIT PAGE 6

- 2 - REAR SUPPORT BRACKETS (RT & LT)
- 2 - 1 " X 7/8 SPACERS WITH 7/16 DIA. HOLE
- 2 - 7/16 X 2 1/2 BOLTS
- 4 - 7/16 SAE FLATWASHERS
- 4 - 7/16 X 1/8 NYLON FLATWASHERS
- 2 - 7/16 TAP LOCKNUTS

FRONT MOUNTING BRACKET KIT PAGE 3 & 7

- 2 - RAINGUTTER MOUNT BRACKETS
- 2 - RAINGUTTER BOTTOM CLIPS
- 2 - MIDDLE SUPPORT BRACKETS
- 2 - TOP SUPPORT PLATES
- 2 - STRIPS SOFT VELCRO PADDING
- 4 - 3/8 X 1/4 BLACK PLASTIC SPACERS
- 8 - 5/16 X1 CARRIAGE BOLTS
- 10 - 5/16 FLATWASHERS
- 4 - 5/16 REGULAR NYLON LOCKNUTS
- 6 - 5/16 THIN NYLON LOCKNUTS
- 6 - 3/8 X 1 1/4 CARRIAGE BOLTS
- 6 - 3/8 NYLON LOCKNUTS
- 6 - 3/8 FLATWASHERS

Part#44099
Jeep JK Unlimited Adventure Half Rack (Hardtop Models Only!)

Installation Instructions

1. Leave all fasteners loose or slightly tighten to hold in place. This will make installation easier.
2. The Adventure rack was designed using a stock factory rear bumper. The Garvin Wilderness G2 Series Bumper is compatible with the Adventure Rack. Other aftermarket rear bumpers may require slight modification to work with the rack.
3. For general assembly a passengers side view of the Adventure Half Rack is drawn on page 3.
4. Remove factory rear bumper. Remove both outside frame/bumper brackets (16mm or 5/8 Socket), remove the top bolts that hold the bumper to the frame crossmember brackets.
5. Remove the rear factory tail lights, refer to page 4.
6. Install lower support brackets to inside threaded brackets as shown on page 5.
7. Align and tighten 3/8" dia. nut and lockwasher on lower support bracket. Do not tighten the allen pointed set screws at this time.
8. Install all four rubber bump stops to rear support arms, refer to page 8.
9. Install rear support brackets to lower supports as shown on page 6. Slightly tighten to hold in place.
10. Install rear connecting tube 38" to supports as shown on page 6. Align and slightly tighten to hold in place.
11. Install top sidebar tubes to rear supports, as shown on page 3. Slightly tighten to hold in place.
12. Install front connecting tube (28 7/8") to side tubes. Slightly tighten to hold in place, refer to pages 3 & 7.
13. Assembly and install front mounting clamps to rain gutter of hardtop. Align with front clamp mounting bracket on top sidebar tube. Refer to pages 3 and 7.
14. Raise up the rack and connect to the front mounting using the top support plates as shown on pages 3 and 7.
15. Install top support crossbar to top sidebar tubes, refer to page 3.
16. Align the Adventure Half Rack so the rear supports are centered on the Jeep. This can be done by slightly loosening the 7/16 x 2 1/2 connecting bolt, and adjusting the lower rubber bump stops until the support arms are centered and finally re-tighten the bolts.
17. Center the front of the rack and tighten all fasteners.
18. Re-check roof rack alignment and re-check all fasteners for being tight. After rack is aligned and all fasteners tightened, use the 5/32 allen wrench to tighten all of the pointed allen set screws in the lower support bracket into the lower body flange. Secure with 5/16 jam nuts. Re-install factory rear bumper.
19. Adjust all four large rubber bump stops as directed on page 8 and tighten.

Weather Proofing Connecting Joints:

- Back out the 5/16 button head allen bolts approx. 1/4" from the tubes. Apply black silicon to the threads and hole. Re-tighten bolt.
- Apply black silicon around the area where the front and rear tubes slide over the supports.
- Touch up all nicks and scratches that normally occur with a black enamel paint.

WILDERNESS PRODUCTS JK SHORT ADVENTURE RACK 2007-2014 4 DOOR HARD TOP MODEL

GENERAL DRAWING --- PASSENGERS SIDE SHOWN

PART# 44099

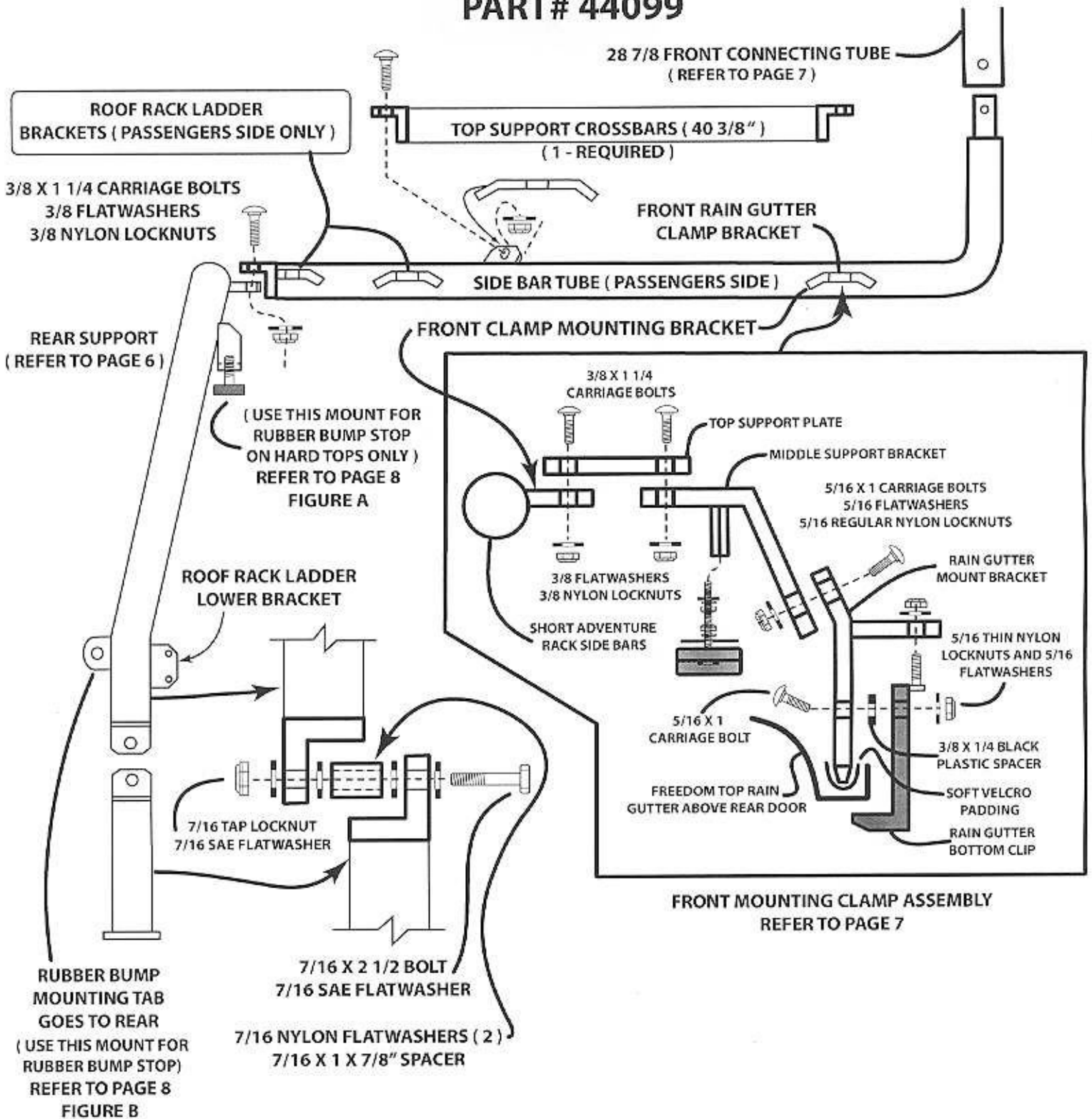

PART# 44099

- 1 - REMOVE THE TAILLIGHT FROM EACH SIDE.
- 1a- ON 2012 MODELS OPEN THE TAILGATE TO REMOVE THE ARM ON PASSENGERS SIDE BEHIND THE TAIL LIGHT.
- 2 - REMOVE THE PAD THAT IS IN THE BOTTOM, (2012 MODELS CUT OUT THE SPRAYED IN FOAM THAT COVERS THE HOLE (DRIVERS SIDE ONLY)
- 3 - INSTALL THE INSIDE THREADED SUPPORT BRACKET IN THE SMALL HOLE AS SHOWN, FIGURE A , RE-INSTALL PADS AND TAIL LIGHTS.

FIGURE A

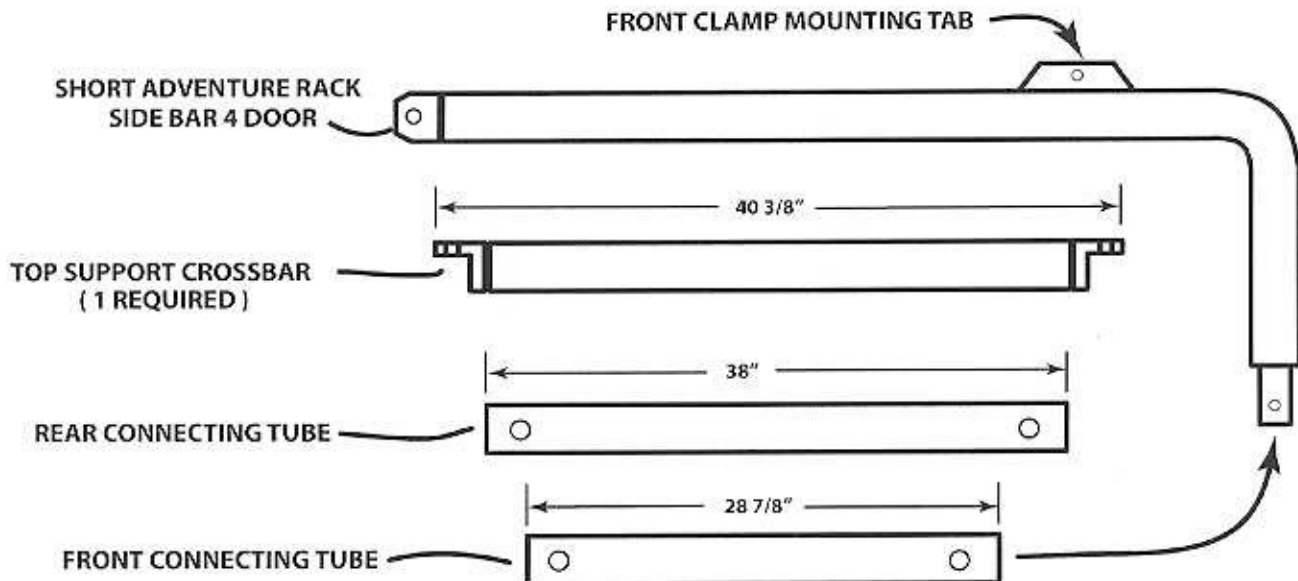
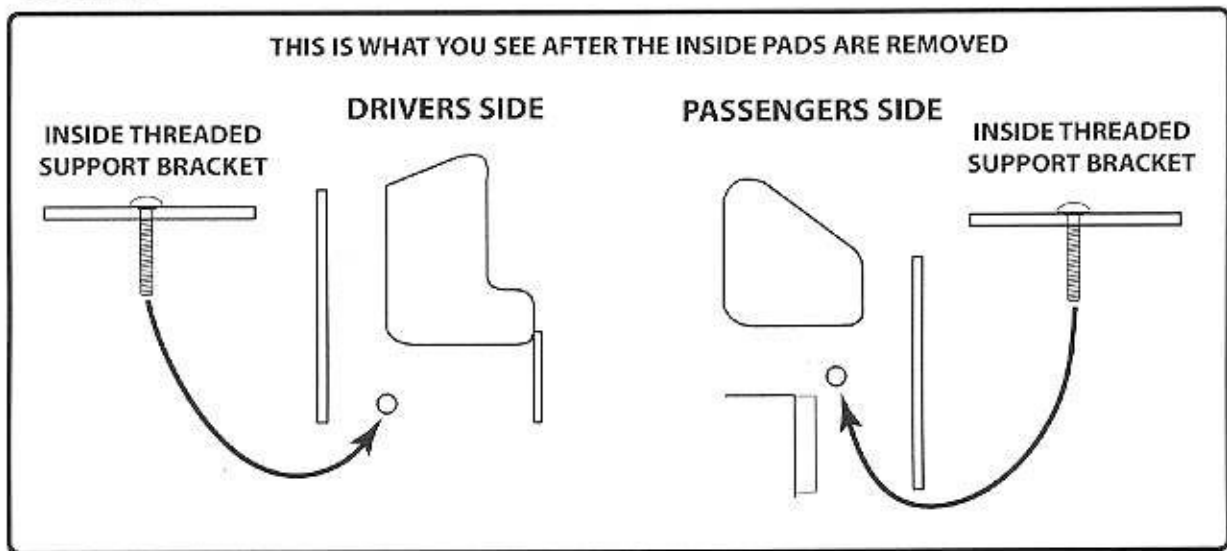

- 4 - INSTALL THE LOWER SUPPORT BRACKETS AS SHOWN , TO THE INSIDE THREADED SUPPORT BRACKETS AND THE BODY FLANGE. ALIGN AND TIGHTEN
- 5 - INSTALL 5/16 ALLEN SET SCREWS AND JAM NUTS, SLIGHTLY TIGHTEN SET SCREWS TO LOWER BODY FLANGE TO HOLD IN PLACE , WILL TIGHTEN LATER AND LOCK WITH JAM NUTS LATER.
- 6 - WHEN INSTALLING THE LOWER SUPPORT BRACKET, THE RUBBER BUMP STOP BRACKET GOES TO THE REAR, AS SHOWN IN FIGURE B.

FIGURE B (PASSENGERS SIDE SHOWN)

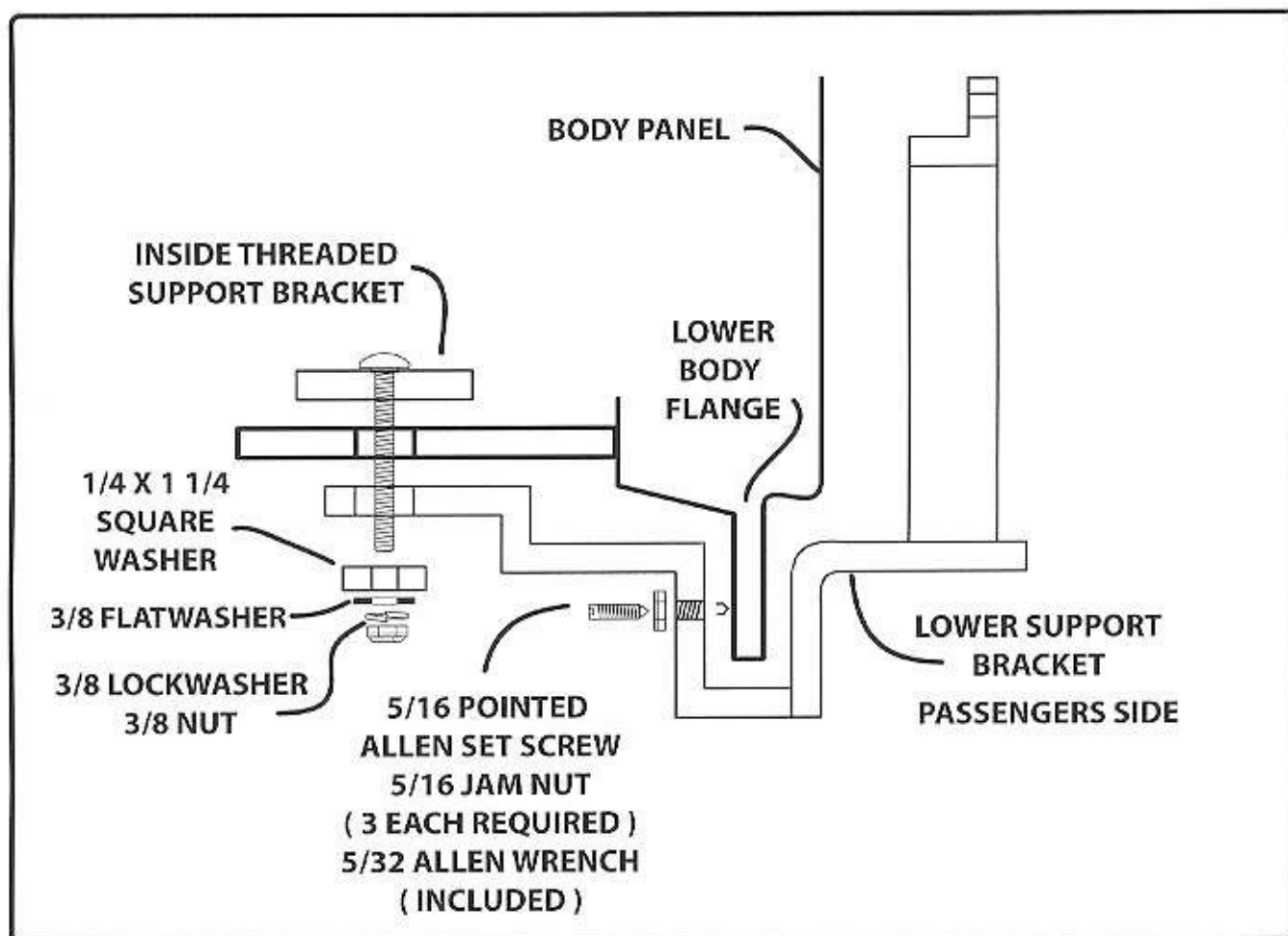

**REAR TOP SUPPORT BRACKET AND REAR CONNECTING TUBE
INSTALLATION DRAWING
(PASSENGERS SIDE SHOWN)**

REAR CONNECTING TUBE 38" LONG

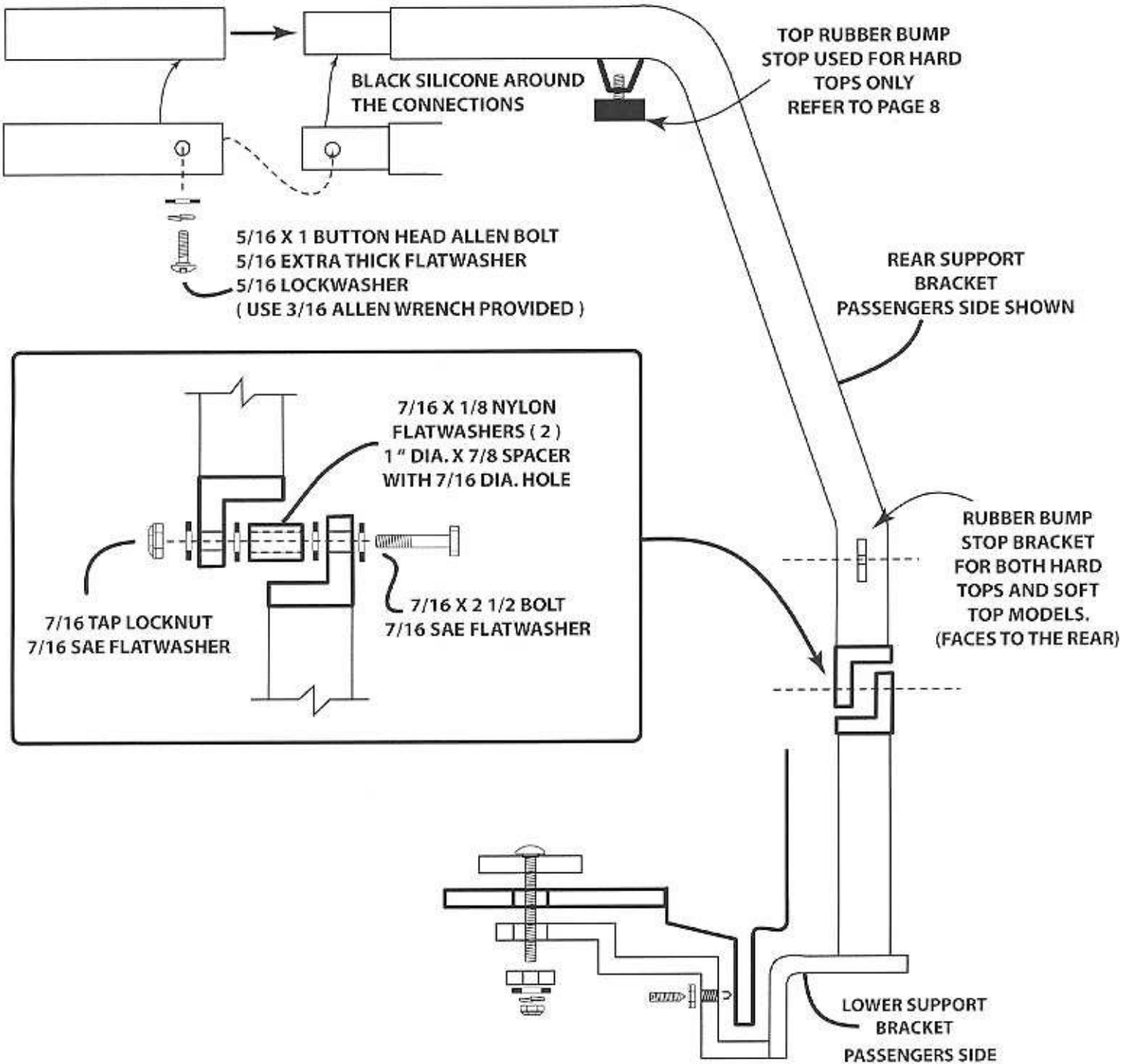

**FRONT CLAMP ASSEMBLY AND
INSTALLATION INSTRUCTIONS**

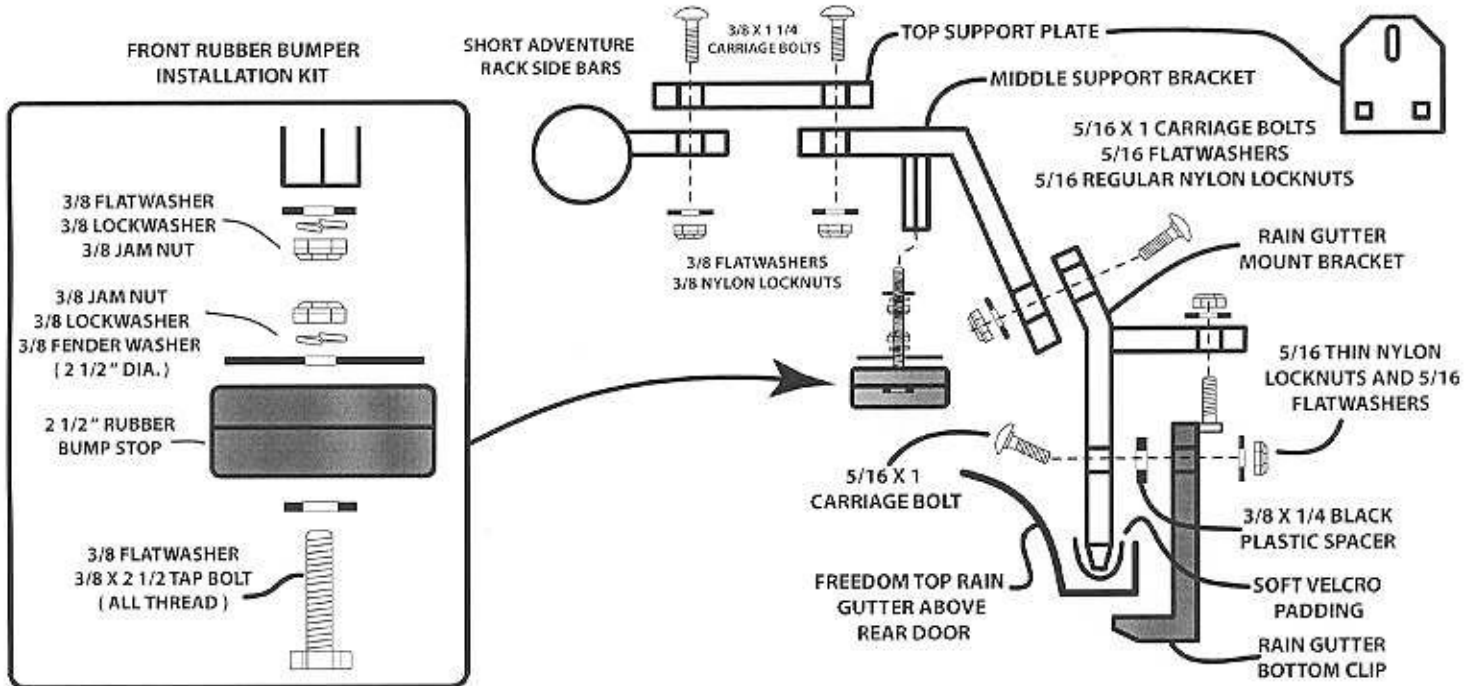

FRONT CONNECTING TUBE INSTALLATION

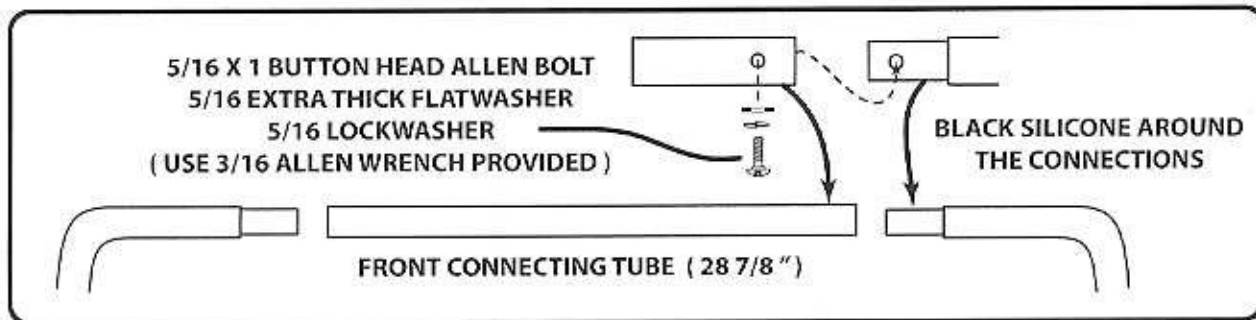

- 1- INSTALL VELCRO PAD TO BOTTOM OF RAIN GUTTER MOUNTING BRACKET.
- 2 - INSTALL THE BRACKET INTO RAIN GUTTER INLINE WITH THE MOUNTING TAB ON THE ROOF RACK SIDE TUBE.
- 3 - INSTALL THE RAIN GUTTER BOTTOM CLIP AS SHOWN , LEAVE LOOSE FOR LATER ADJUSTMENT
- 4 - ASSEMBLE AND INSTALL THE FRONT RUBBER BUMP STOP AS SHOWN AND THEN SCREW INTO THE SUPPORT BRACKET. SCREW THE BUMP STOP ALL THE WAY IN AND LEAVE LOOSE.
- 5 - INSTALL THE MIDDLE SUPPORT BRACKET TO THE RAIN GUTTER BRACKET AS SHOWN, AND SLIGHTLY TIGHTEN.
- 6 - ADJUST THE RUBBER BUMP STOP DOWN TILL IT TOUCHES THE TOP AND THE CLAMP IS LEVEL.
- 7 - CONNECT THE FRONT RAIN GUTTER MOUNT TO THE SIDE ROOF RACK TUBE AS SHOWN, USING THE TOP SUPPORT PLATE.
- 8 - CENTER ROOF RACK ON MOUNTING BRACKETS AND TIGHTEN ALL FASTNERS.

- 1 - FREEDOM TOP MODELS, USE THE UPPER AND LOWER BUMP STOPS (FIGURES A & B)
- 2 - SOFT TOP MODELS, USE ONLY THE LOWER BUMP STOP (FIGURE B)
- 3 - ASSEMBLE THE RUBBER BUMP STOP TO THE TAP BOLT AND FENDER WASHER AND TIGHTEN
- 4 - INSTALL THE RUBBER BUMPS TO THE MOUNTING BRACKETS ON THE REAR SUPPORTS AS SHOWN FIGURE A & B. INSTALL BUMP STOPS BEFORE INSTALLING REAR SUPPORTS TO VEHICLE.
- 5 - AFTER COMPLETING THE RACK INSTALLATION, ADJUST THE BUMP STOP SO THAT THE RUBBER HAS SLIGHT PRESSURE ON THE FREEDOM TOP / BODY. SECURE WITH NUTS AS SHOWN.
- 6 - THE RACK SHOULD NOT MOVE, IF THE BUMP STOPS ARE ADJUSTED CORRECTLY.
- 7 - ON SOFT TOP MODELS, PUTTING EXCESSIVE WEIGHT ON THE REAR HALF OF THE RACK WILL CAUSE THE LOWER BUMP STOPS TO SLIGHTLY PULL AWAY FROM THE BODY, IF THIS HAPPENS RE ADJUST THE LOWER BUMP STOPS BEFORE MOVING THE VEHICLE.
- 8 - USE SOME VASOLINE JELLY ON THE RUBBER IF A SQUICKING NOISE IS HEARD, THE RUBBER WILL GET HARD OVER TIME.

FIGURE A (HARD TOPS ONLY)

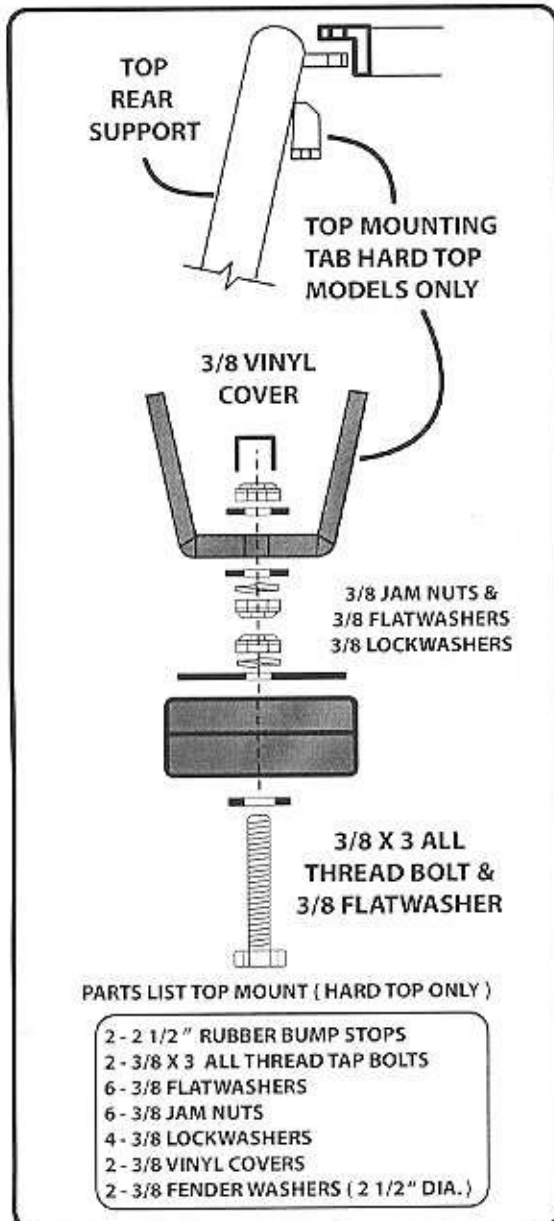

FIGURE B (HARD TOPS AND SOFT TOP MODELS)

